



## **Set Up Instructions for AFK & Roll Out Awning Walls**

These instructions are supplied as a guide only, we recommend you read through these as well as watching the videos on our website, [www.alpineannexes.com.au](http://www.alpineannexes.com.au) before you set up your annexe.

We are always happy to assist and recommend where possible that you have a practice run at

setting up your new annexe before you head off on holidays. 

### **A Few Tips to assist:**

- Make sure your van is level.
- Ensure the keyway slot in the barrel, of the awning, is set to the 9o'clock position when you are looking at the end of the barrel, from the front of your van (**Refer to Diagram 1**)
- The fitter will put a small mark on the end of the drum, this should be lined up to the center of the awning leg. (**Refer to Diagram B**) this will ensure your awning is in the correct position and that the awning vinyl rolls over the drum and does not create a gutter effect behind the drum where water can gather and pond. (**Refer to Diagram C**)
- The fitter will mark the legs of your awning, to the setup position, these are intended as a guide only, for the height to set the awning up, if you are on unlevel ground, adjust accordingly.
- The **AFK (Anti-Flap Kit) (Refer to Diagram A)** has 3 sail track slots in it, 2 on the inside and 1 on the outside (Older AFK's may only have the 2 inside tracks) the Side walls slide into **Slot A** on the inside, **Slot B** is to accommodate a veranda if you have one. **Slot C** on the outside is not used.
- **When installing the roll out awning walls, don't install the AFK first, slide the A wall up the van first,** then slide the AFK onto the top of the wall, once on, hook AFK on to the van, push spigot into hole in the drum and tighten the Knurl Knob
- Once you have the awning in the correct position and the Curved Rafters in place, flick the switch on the awning to the roll up position, this will prevent your awning drum from being able to unroll further out and keep it taught, **IMPORTANT NOTE:** remember to flick it back to the roll out position prior to packing up.
- We highly recommend using Awning Clips and good quality tie downs, this will stop the awning from rolling out of position and tether it securely to the ground (**See Diagrams C and E**)



## Alpine Annexes

Fac 30/513 Maroonah Hwy, Ringwood,3134

P: (03) 9870 6102

E: [sales@alpineannexes.com.au](mailto:sales@alpineannexes.com.au) Web: [www.alpineannexes.com.au](http://www.alpineannexes.com.au)

**Diagram A:** This is a sample of the B Wall (Back Wall AFK)

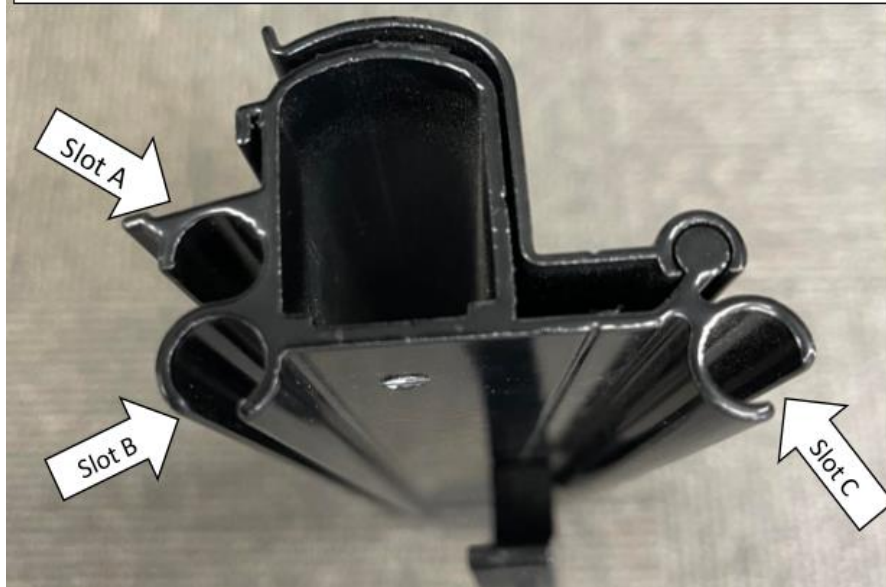

**Diagram B**



**Diagram C**



**Diagram D**

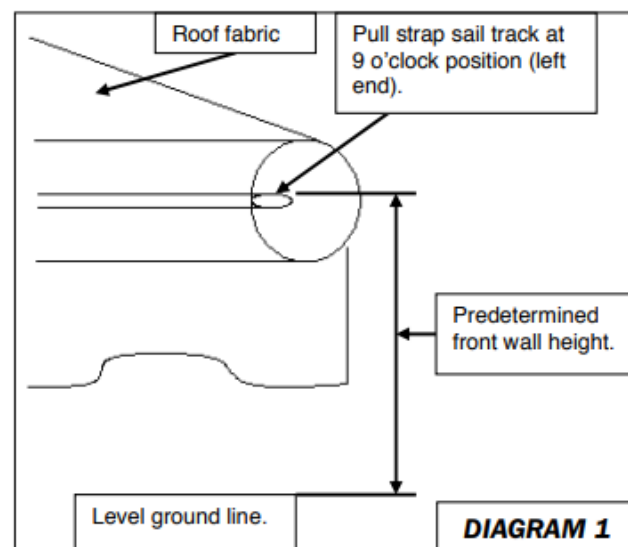

**Diagram E**



## Set Up Instructions for AFK

1. Erect awning as per manufacturer's instructions. Height of legs, need to be set at the pre-determined height, to suit the Annexe wall measurements.
2. Ensure the sail track groove in roller, is set at the 3 o'clock position at right end of drum or 9 o'clock position at left end of drum. This position will allow water to runoff the awning. **(Refer diagram 1)**



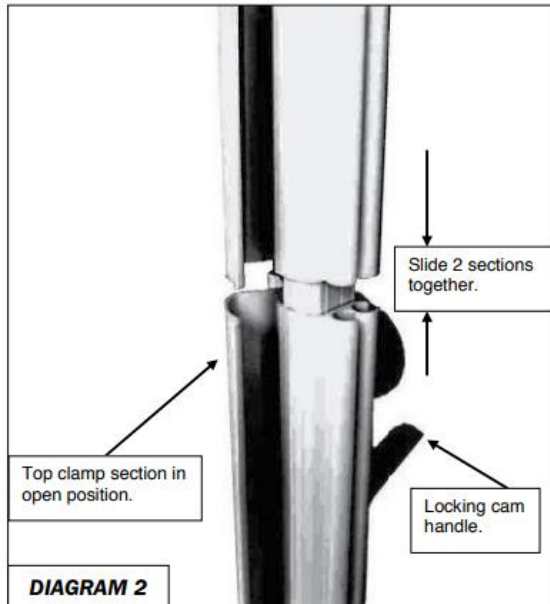

- Unpack AFK from carton. Select the two sections which fit to the roof rail brackets on caravan. These 2 sections have a joiner piece fitted inside which are installed upside down for packaging purposes. Remove the 2 set screws, slide the joiner piece out, reverse the direction and re-fix in place using the original set screws. Release the locking cam handles and ensure the top clamp section of the AFK is in the open position. Now slide on the spigot end sections of the AFK and join together (**Refer diagram 2**)

- Fit the hook end into the roof rail bracket on van, ensuring the top clamp section of the AFK is in the open position. Lift the AFK up until it rests just under the awning fabric. Extend the AFK out until the spigot fits into the hole in the roller. Fully extend the AFK and tighten the knurl knob. (**Refer diagram 3,3A,3B**)

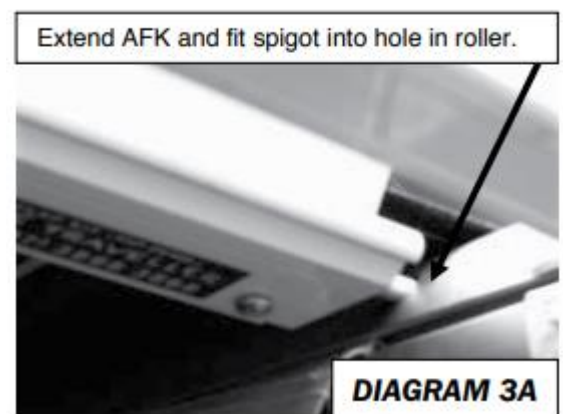

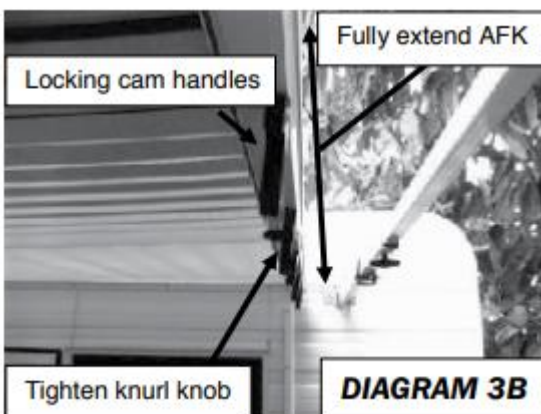
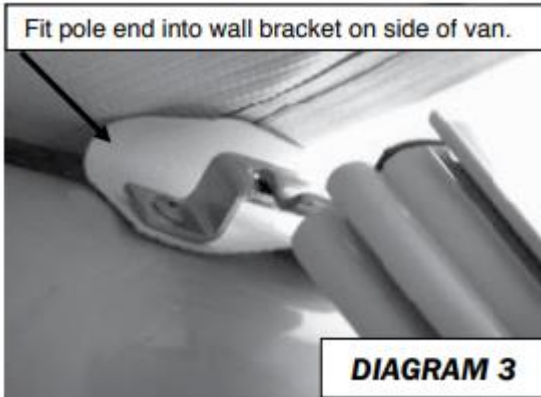

5. With one hand, hold the fabric on top of the AFK at the gap in middle of 2 AFK sections, then tighten the locking cam handles with the other hand (refer diagram 3B). Make sure awning fabric is securely clamped by AFK (**Refer diagram 4**)



## Set Up Instructions for Roll Out Awning Walls

At Alpine Annexes we design our roll out awning annexes with three main factors in mind, **Premium Quality, Strength, and Ease of use.**

All our annexes are measured and made by hand, specifically to fit your van.

We recommend you have a practice run before you take your first trip, so we are close by if you need any assistance.

### Roll Out Awning Annexe

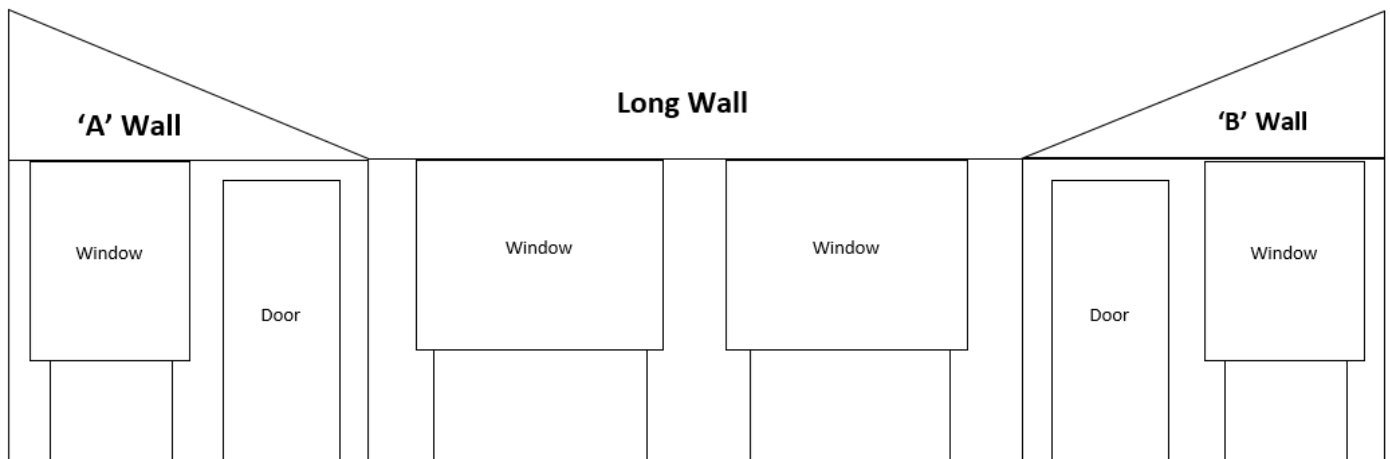

Diagram 6

### Steps

1. Feed the long wall into sail track groove on roller (adjust awning legs to suit wall height).
2. Slide the 'A' Wall up the sail track on the van, slide the AFK on to the top of the wall, be sure to slide the wall into slot A (**Refer to Diagram A on Page 1**)
3. Hook the flat hook into the bracket on your van and push the spigot into the hole in the drum, tighten Knurl Knob
4. Repeat at B end with back wall.
5. Maneuver long wall so it's even and join to A & B wall with Velcro.
6. Ensure all the zips are done up and Peg to ground.